

THE LOAD / PULL INDUCED TO THE OPERATOR
 COULD BE AS HIGH AS 2000 LBS WHILE THE
 DOOR IS BEING OPERATED. MAKE SURE THAT
 THIS MOUNTING PAD HAS THE STRENGTH TO
 SUPPORT THESE LOADS.

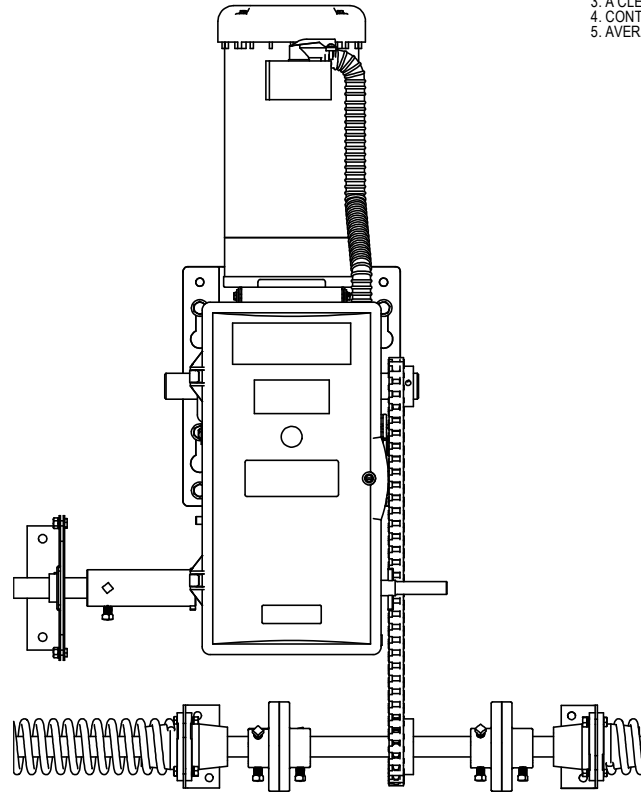

NOTES:

1. PLEASE VERIFY VOLTAGE, PHASE & MOUNTING.
2. ALL OPTIONAL ARE AT ADDED COST.
3. A CLEARANCE OF 6" SHOULD BE ALLOWED FOR ACCESS TO ELECTRIC BOX.
4. CONTROL VOLTAGE IS A NEC CLASS 2 CIRCUIT.
5. AVERAGE DOOR TRAVEL SPEED VARIES PER DRUM USED.

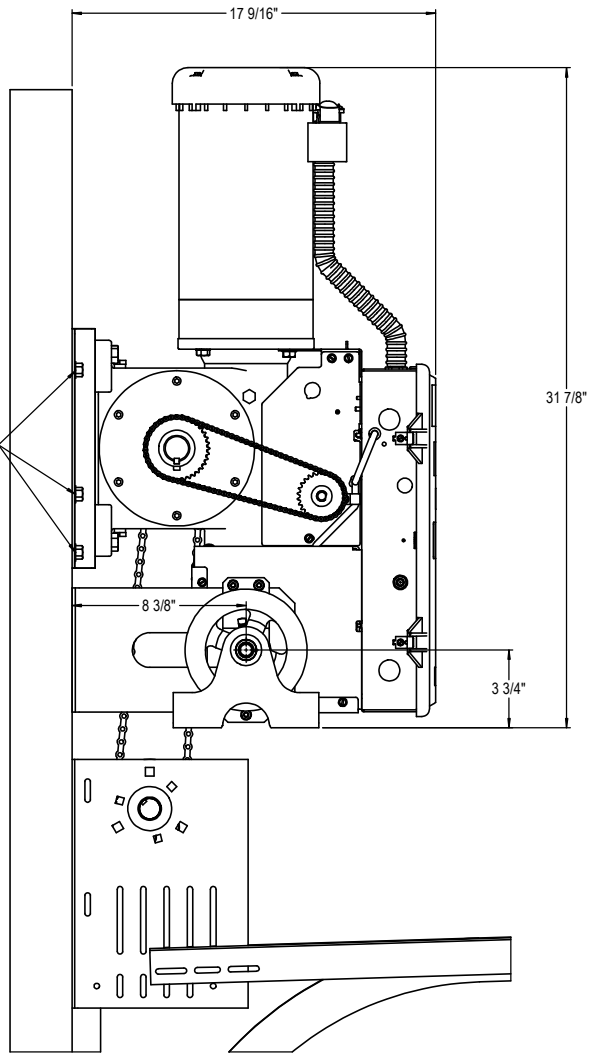
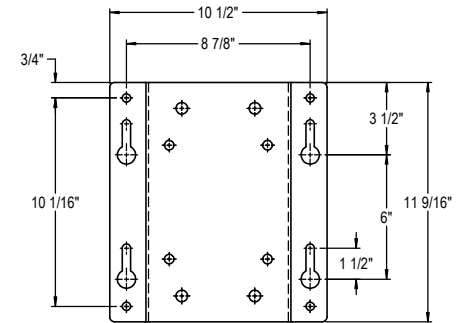

WALL MOUNT BRACKET

ELECTRIC OPERATOR: GCL-GH (HEAVY DUTY) (3 HP)

DOOR TYPE: SECTIONAL

MOUNTING TYPE: CENTERMOUNT CHAIN COUPLE

PROJECT:

ARCHITECT:

CONTRACTOR:

DISTRIBUTOR:

PLANT:

DRAWN BY: DATE:

APPROVED BY: DATE:

DWG NO. SHT ___ OF ___

ENG. CERT. NO.

ARCHITECT DOOR NUMBER	QTY	FACTORY ORDER NUMBER	MOUNT TYPE	VOLTS					PHASE		CONTROL STATION			
			CENTERMOUNT	115	208	230	460	575	1 PHASE	3 PHASE	3 BTN	KEY SWITCH	EXT. FLUSH 3 BUTTON	

112312.0001 REV.-

